

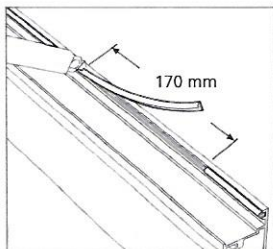

Préparation · Preparation · Vorbereitung

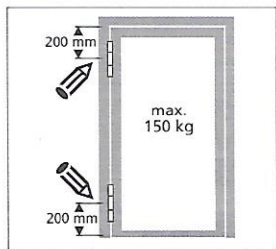

Montage de la paumelle à clamer · Installation of clamp hinge · Montage des Klemmbandes

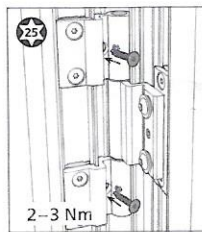
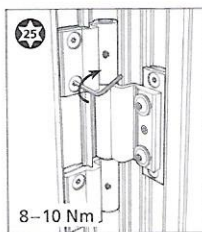
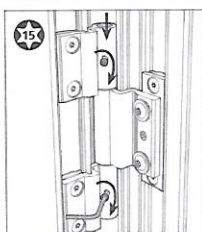
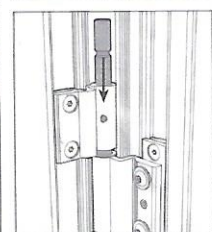
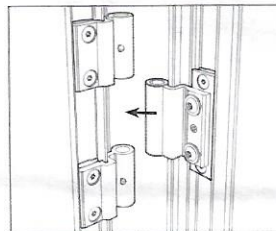
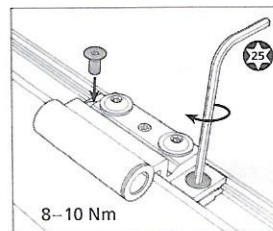
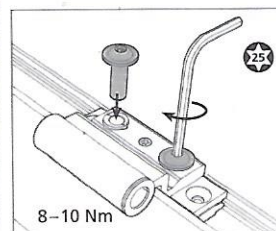
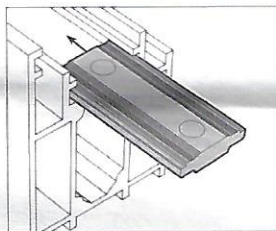
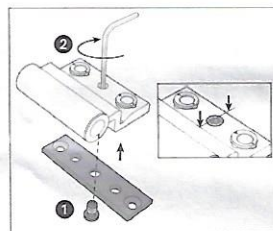
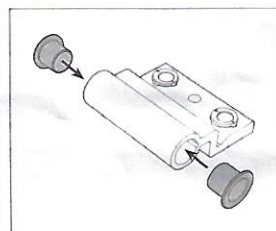
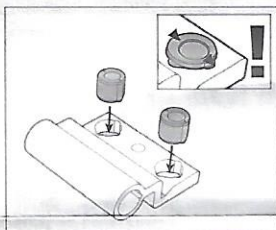
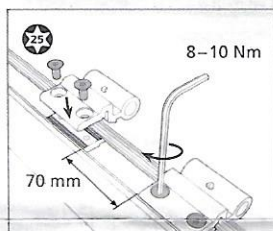
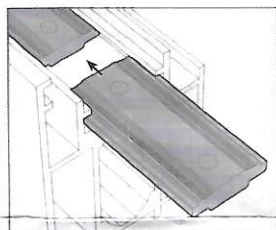



Réglage horizontal · Horizontal adjustment · Horizontalverstellung

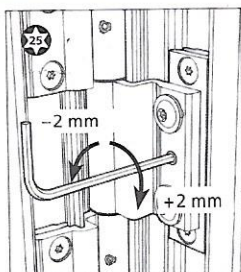

Calez le vantail avant d'effectuer les réglages.

Support door leaf prior to adjusting.

Flügel vor Verstellung unterstützen.



Réglage de la compression du joint · Adjusting the sealing pressure · Dichtungsdruck verstellen

